

HOMES THAT **MOVE** YOU



Royal Oaks
HOMES THAT **MOVE** YOU



Guilford
Elevation A

www.RoyalOaksBG.com

Square Footage

First Floor	2073 sq.ft.
Second Floor	731 sq.ft.
Total	2804 sq.ft.
Bay Window	27 sq.ft.

Overall Width: 59'0"

Overall Depth: 57'0"

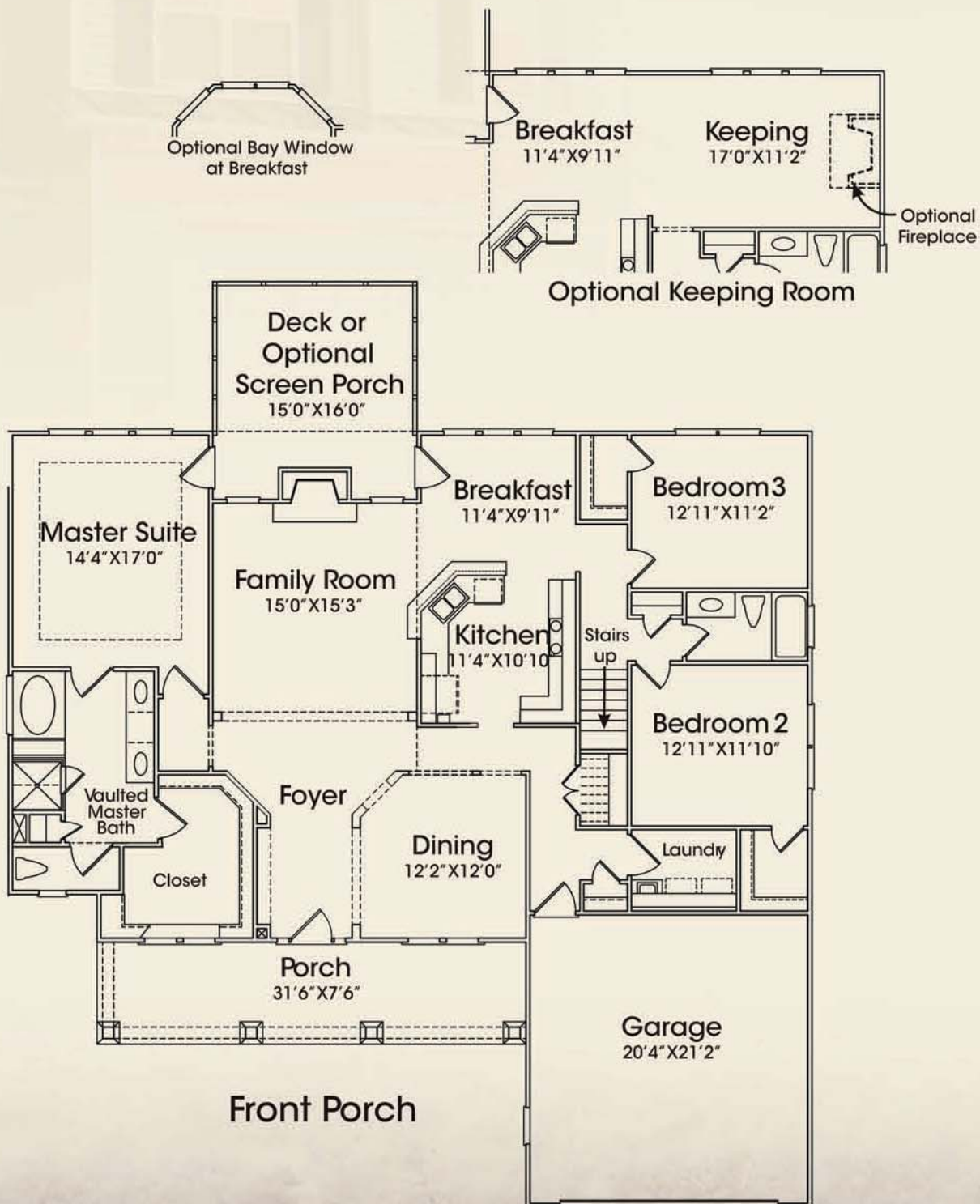

Square Footage

First Floor	2073 sq.ft.
Second Floor	731 sq.ft.
Total	2804 sq.ft.
Bay Window	27 sq.ft.

Overall Width: 59'0"

Overall Depth: 57'0"

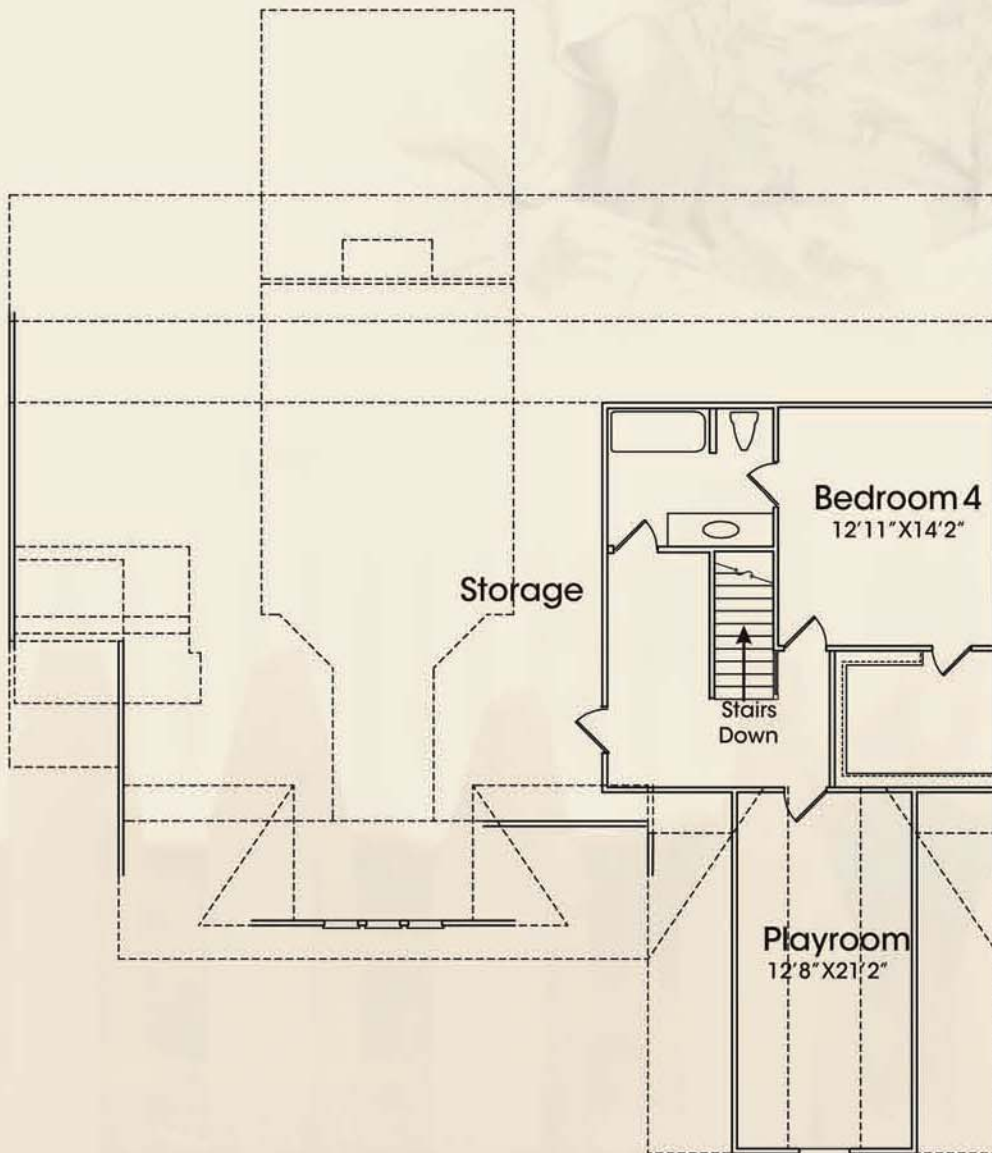

Guilford



Elevation "A"



Elevation "A"
with Stone Veneer

All sizes and dimensions are approximate. All features, design and prices are subject to change without notice. Floor plans may vary with selected elevations. Cut Sheets and or Brochures are only to be used to indicate locations of upgrades, their purpose is for marketing representation only. 12/08.

www.RoyalOaksBG.com